



Grand Ledge
Public Schools
A Community Committed to Excellence

Board of Education

Jon Shiflett
President

Sara Clark Pierson
Vice President

Patrick McKennon
Secretary

Kim Mulvenna
Trustee

Beverly Winstanley
Trustee

Denise DuFort
Trustee

Ben Cwayna
Trustee



Dr. Brian Metcalf

Superintendent of Schools





Dr. Steven Gabriel

Assistant Superintendent of Schools



Good News - Student Achievement

Over 50 graduates were A.P. Scholars, scoring 3+ on three or more Advanced Placement Exams (earning college credit)

1 in 4 graduates had scored a 3+ on at least one A.P. Exam

When we compare our student achievement results with like districts, our growth trend is exciting.

Good News - Student Achievement

MEAP & M-STEP Proficiency

(Subjects: All and Grades: 3-8)

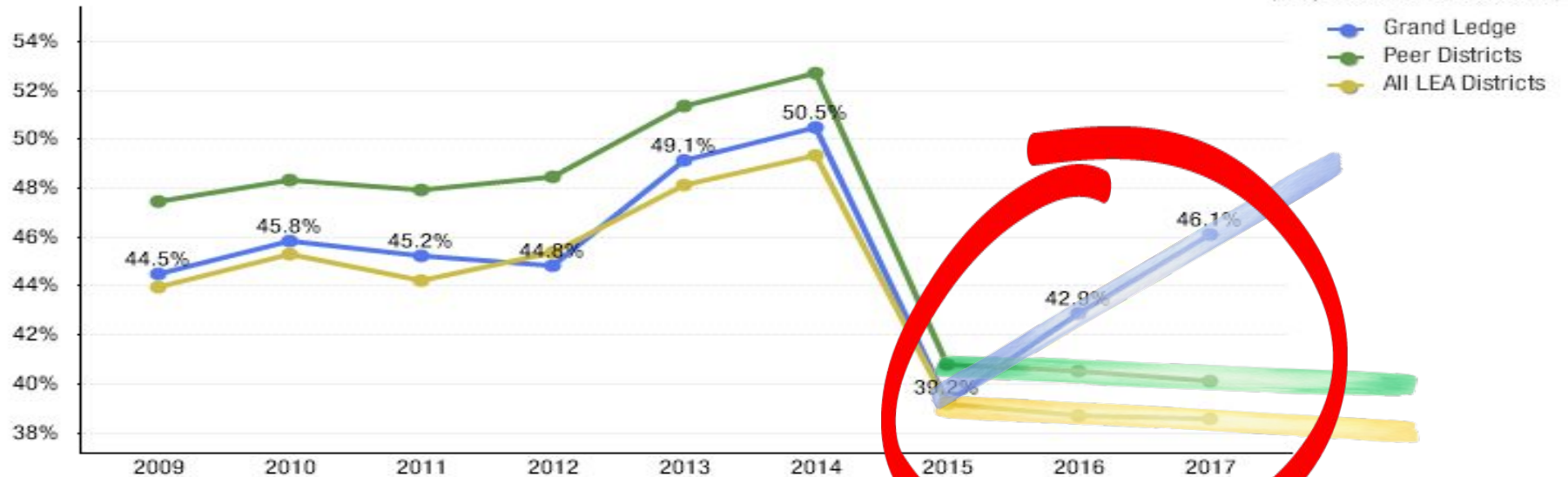

Good News - Financial Stability

Our district's financial stability continues to improve!

- For the first time in 20 years, this district will not “borrow” money to meet payroll this fall.
- Saving the district thousands of dollars in interest payments, from \$50,000 to \$120,000

Good News - Financial Stability

Our financial stability allows the district to:

- Invest in Curriculum
- Support Student Programs
- Provide Professional Development
- Reward Employees

All of which leads to improved student achievement!

Making More Good News in the Future!

On August 13, the Board of Education approved placing two (stand alone) bond proposals on the November 6, 2018 ballot.

- **Proposal 1 - Smarter, Stronger, Safer Schools**
- **Proposal 2 - Community, Athletic, & Fine Arts**

Proposal 1 - Smarter, Stronger, Safer Schools



Create
↑ **SMARTER** ↓
Schools

- District's grade restructuring initiative
- Additional classrooms
- Technology for students & staff



Create
↑ **STRONGER** ↓
Schools

- Upgrade critical needs
- Increase operational efficiencies



Create
↑ **SAFER** ↓
Schools

- Provide secure entrances at all schools
- Improve traffic flow
- Busses to replace aging bus fleet

Proposal 2 - Community, Athletics, & Fine Arts

- Improve fine arts spaces at the High School by adding lobby and support spaces
- Construct a new pool at Beagle (secondary school campus)
- Construct walking track and weight room in old pool area for community and athletic uses
- Improve athletic fields at the “22 acres”



Why a bond? *Where we are & how we got here...*

- 2009/2010 Crisis
 - Grand Ledge Public Schools lost \$470/student
 - **\$2.4 Million Annual Reduction!!!**
 - Closed Greenwood Elementary (reopened as City Hall)
 - Closed Holbrook Elementary (currently Early Childhood Center)
 - Closed Sawdon Alternative High School (students and staff absorbed @ GLHS)
- 2010 - the District restructured to the following to survive crisis
 - Neff Kindergarten Center
 - Beagle, Delta Center, Wacousta, & Willow Ridge: 1-6
 - Hayes: 7-8
 - GLHS: 9-12

Listening to the Community!

- **Focus Groups**
 - Input from students, parents, staff, & community
- **Community Survey**
 - Over 3,000 responses
- **Analyzed Feedback to Create Bond Proposals**

Restructuring for Our Future

If bond passes, the district plans to begin new structure in the 2020-2021 school year.

- Neff & Delta Mills: Early Childhood Centers
- Holbrook: K-4
- Wacousta: K-4
- Willow Ridge: K-4
- Delta Center: K-4
- Hayes Intermediate: 5-6
- Beagle Middle School: 7-8
- Grand Ledge High School: 9-12
- Dave & Betty Morris School Building: agricultural / vocational / STEAM building

Restructuring for Our Future

- Reduce the size (# of students) of elementary buildings
- More appropriately group students based on their development
- Bring the kindergartners home, back to their local elementary
- Provide opportunities for gifted & talented programs at the 5-6 Intermediate School
- Departmentalization of teaching, special facilities, and equipment
 - i.e., science labs, technology labs, band, and choir classes/rooms
- Provide opportunities for HS classes for Beagle MS students
- This plan would enable the Intermediate and Middle Schools to develop extracurricular activities and to provide experiences and leadership specifically for early adolescents.
- Additionally, research suggests that younger children are less intimidated by schoolmates who are no more than four years older than them. This can help to reduce bullying.

Bond 2018 - “What’s this going to cost?!?”

Proposal 1 - Smarter - Stronger - Safer - Schools

- Approximately .89 mill increase over the prior year’s debt millage rate
- Provide \$118,640,000 for three-phase project, ten-year plan

Proposal 2 - Community - Athletics - Fine Arts

- Approximately .55 mill increase over the prior year’s debt millage rate
- Provide \$29,485,000 for one-phase project

Bond 2018 - “What’s this going to cost me?!?””

Increased cost over the prior year to property owners for Proposal 1

MARKET VALUE	TAXABLE* VALUE	COST/ YEAR	COST/ MONTH	COST/ DAY
\$100,000	\$50,000	\$44.50	\$3.71	\$.12
\$200,000	\$100,000	\$89.00	\$7.42	\$.24
\$300,000	\$150,000	\$133.50	\$11.13	\$.37

Bond 2018 - “What’s this going to cost me?!?””

Increased cost over the prior year to property owners for Proposal 1 & 2

MARKET VALUE	TAXABLE* VALUE	COST/ YEAR	COST/ MONTH	COST/ DAY
\$100,000	\$50,000	\$72.00	\$6.00	\$.20
\$200,000	\$100,000	\$144.00	\$12.00	\$.39
\$300,000	\$150,000	\$216.00	\$18.00	\$.59

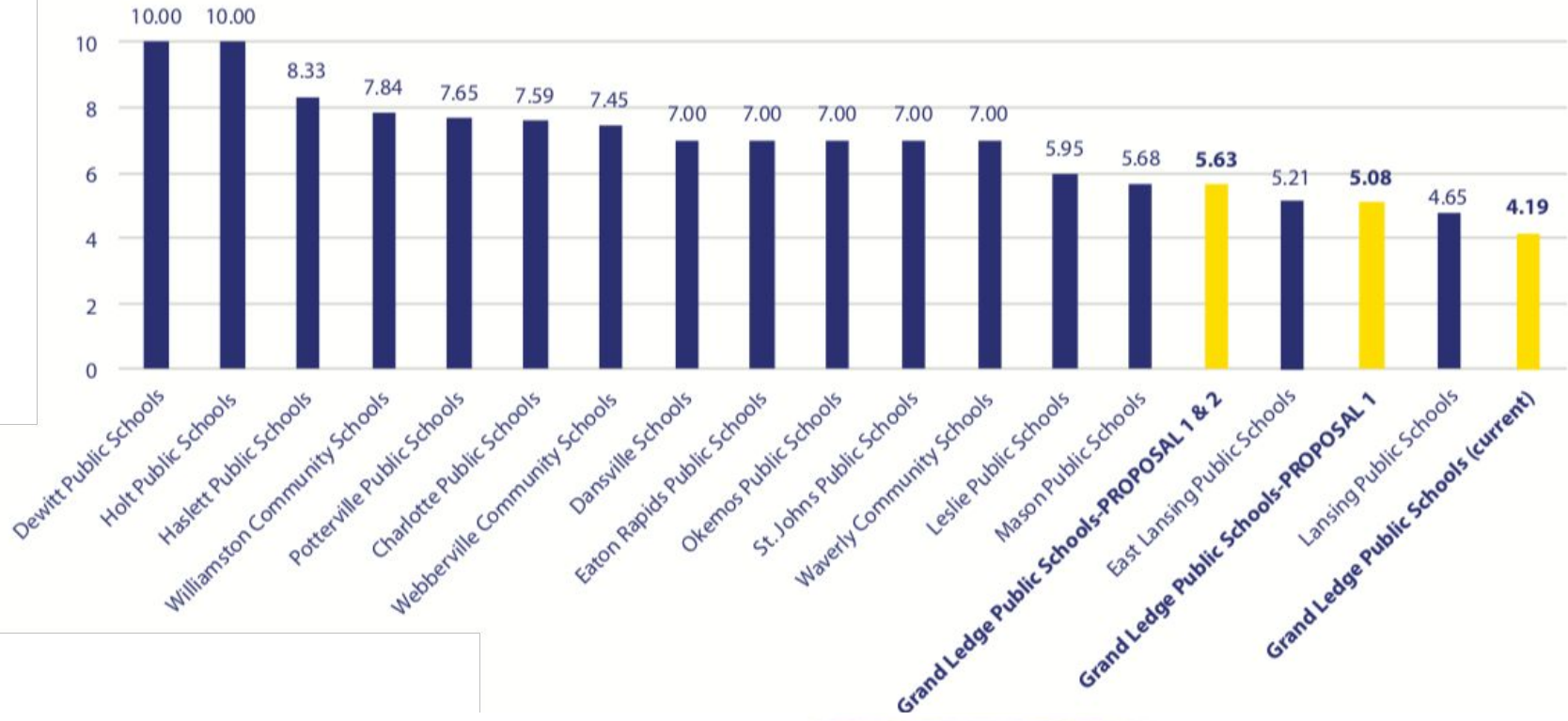

Neff Early Childhood Center

Create **SMARTER** Schools



Create **STRONGER** Schools



Create **SAFER** Schools

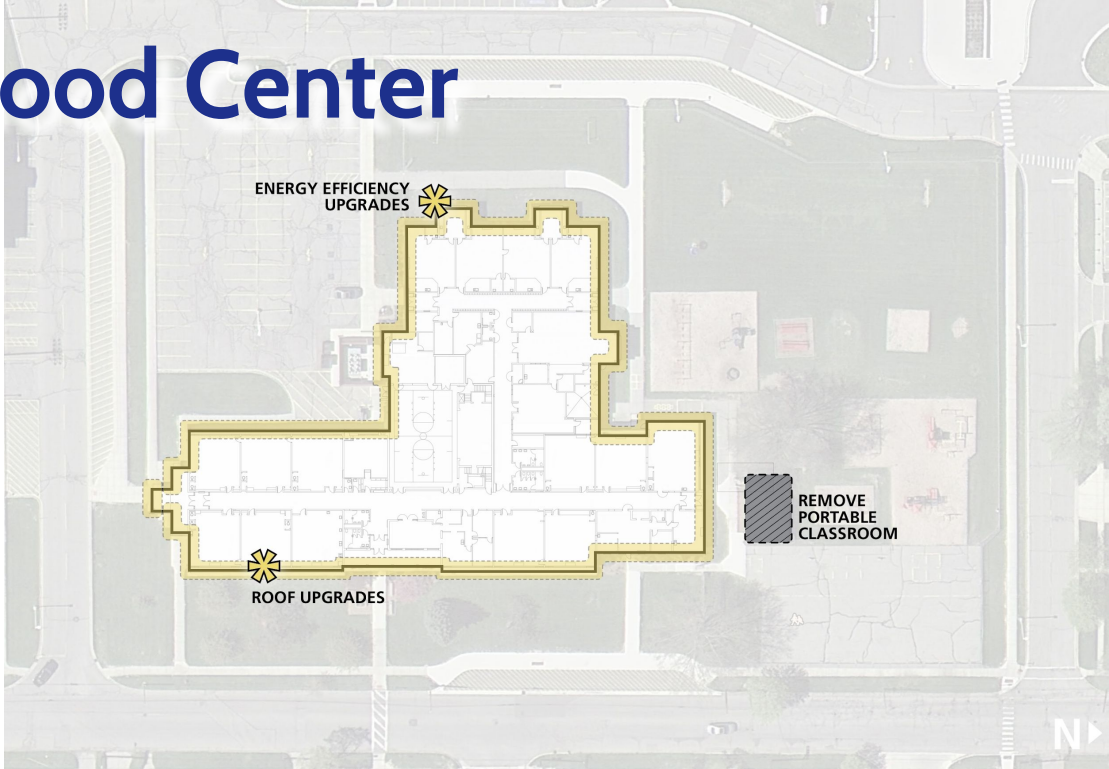

Holbrook K-4 School

Create **SMARTER** Schools

Create **STRONGER** Schools

Create **SAFER** Schools

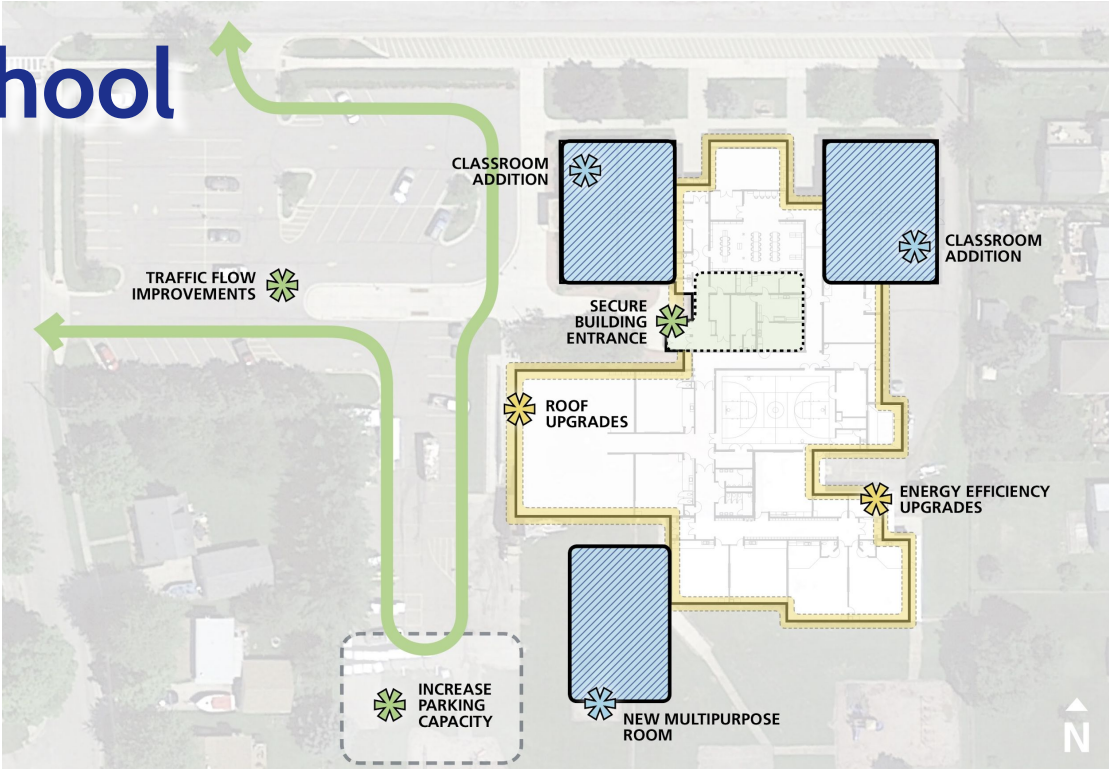

Delta Center K-4 School

Create **↑ SMARTER ↓** Schools

Create **↑ STRONGER ↓** Schools

Create **↑ SAFER ↓** Schools

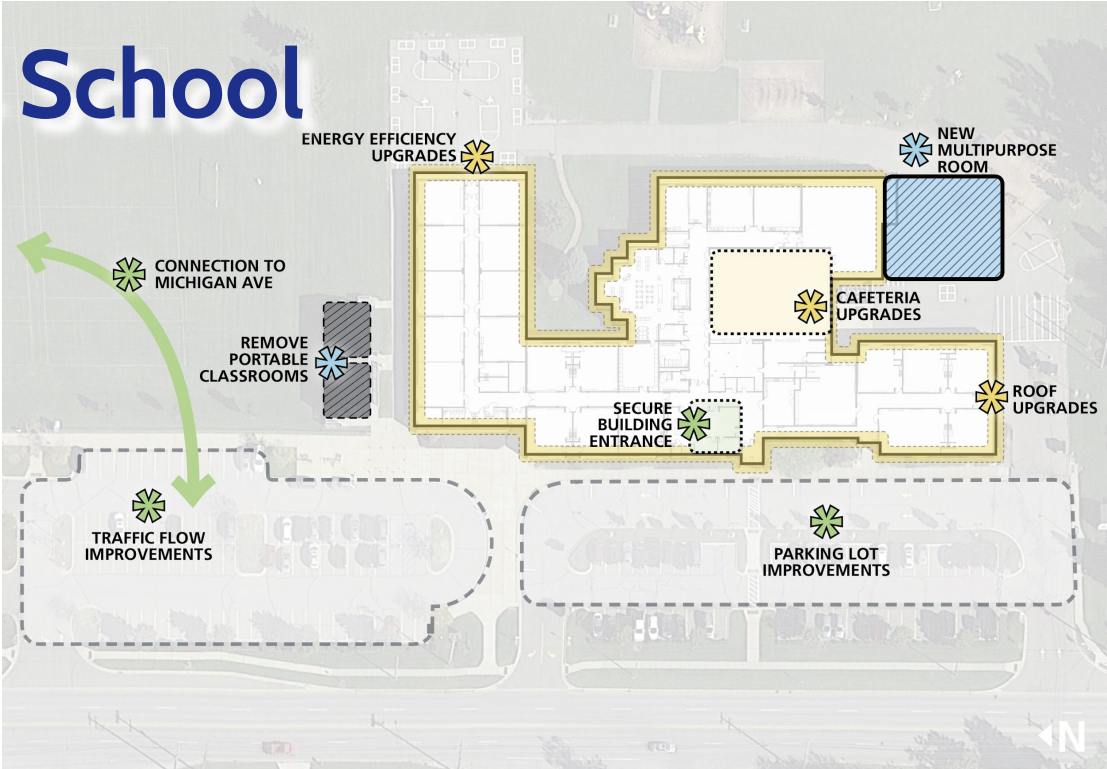

Wacousta K-4 School

Create **SMARTER** Schools



Create **STRONGER** Schools



Create **SAFER** Schools

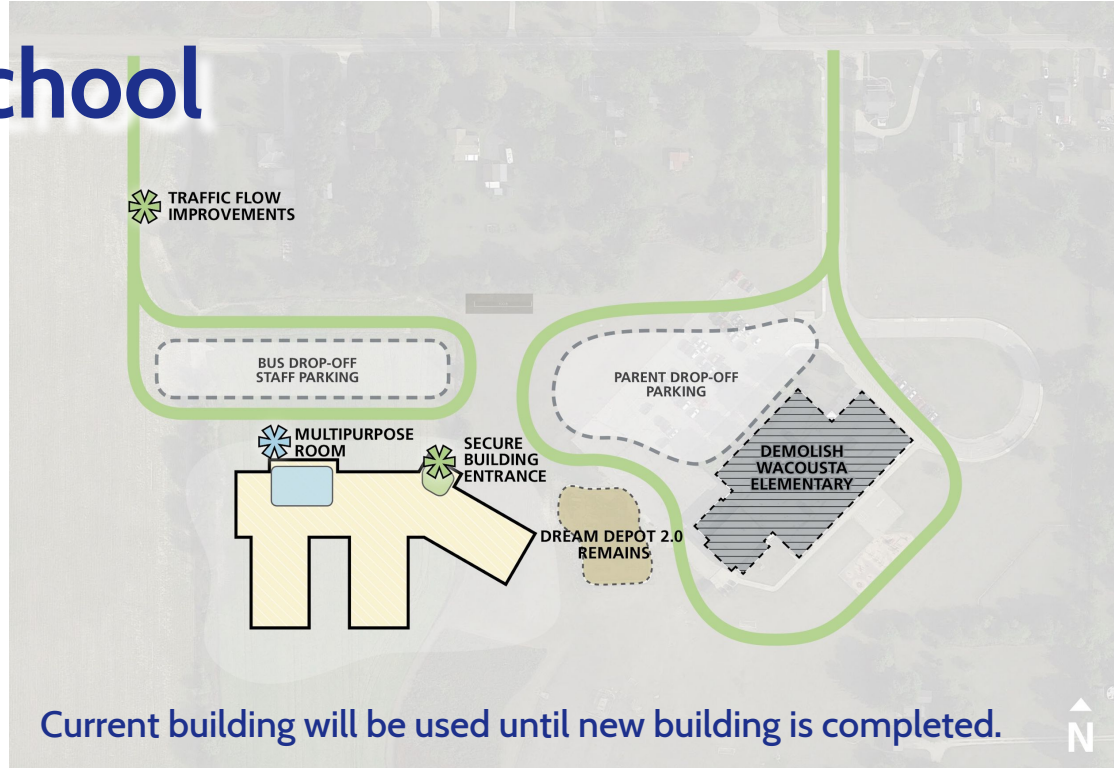

Willow Ridge K-4 School

Create **SMARTER** Schools



Create **STRONGER** Schools



Create **SAFER** Schools

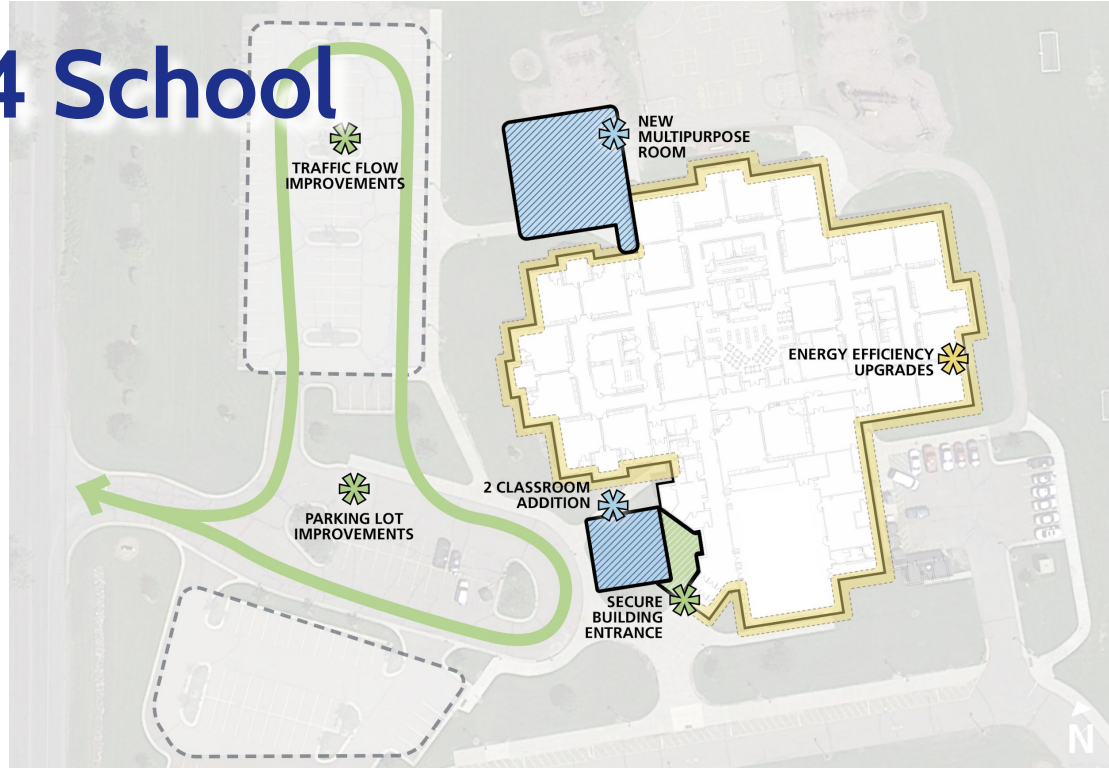

Hayes Intermediate (5-6)

Create **SMARTER** Schools

Create **STRONGER** Schools

Create **SAFER** Schools

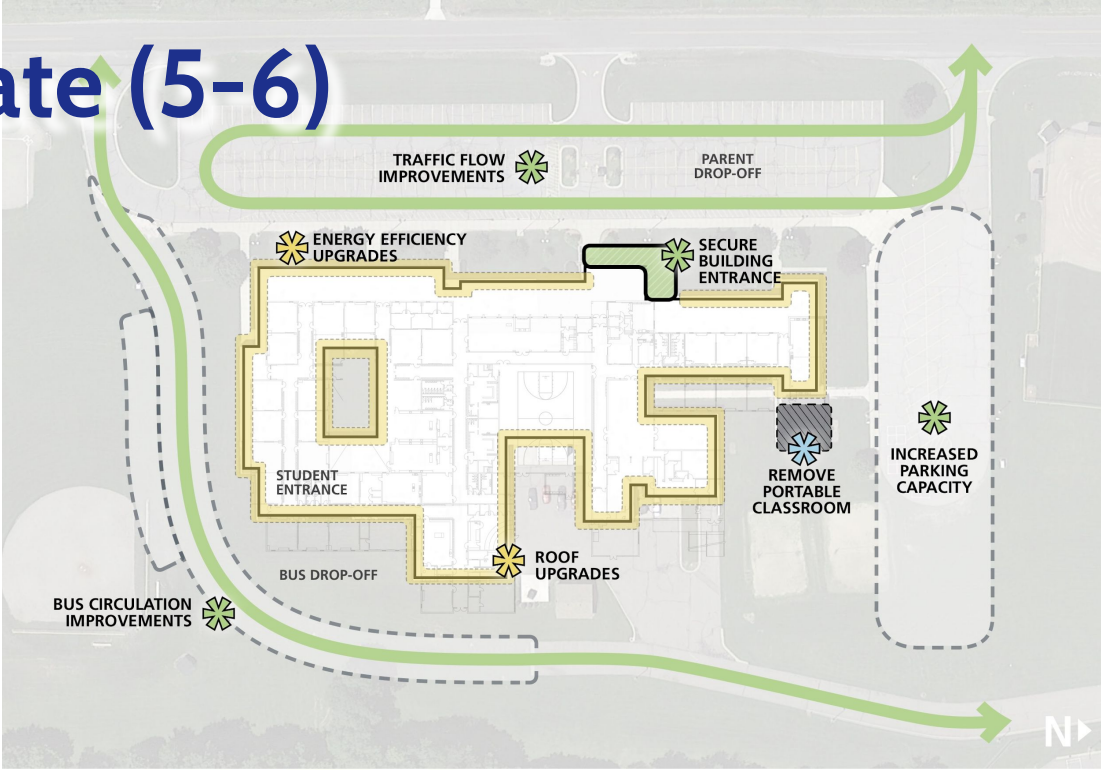

Beagle Middle School (7-8)

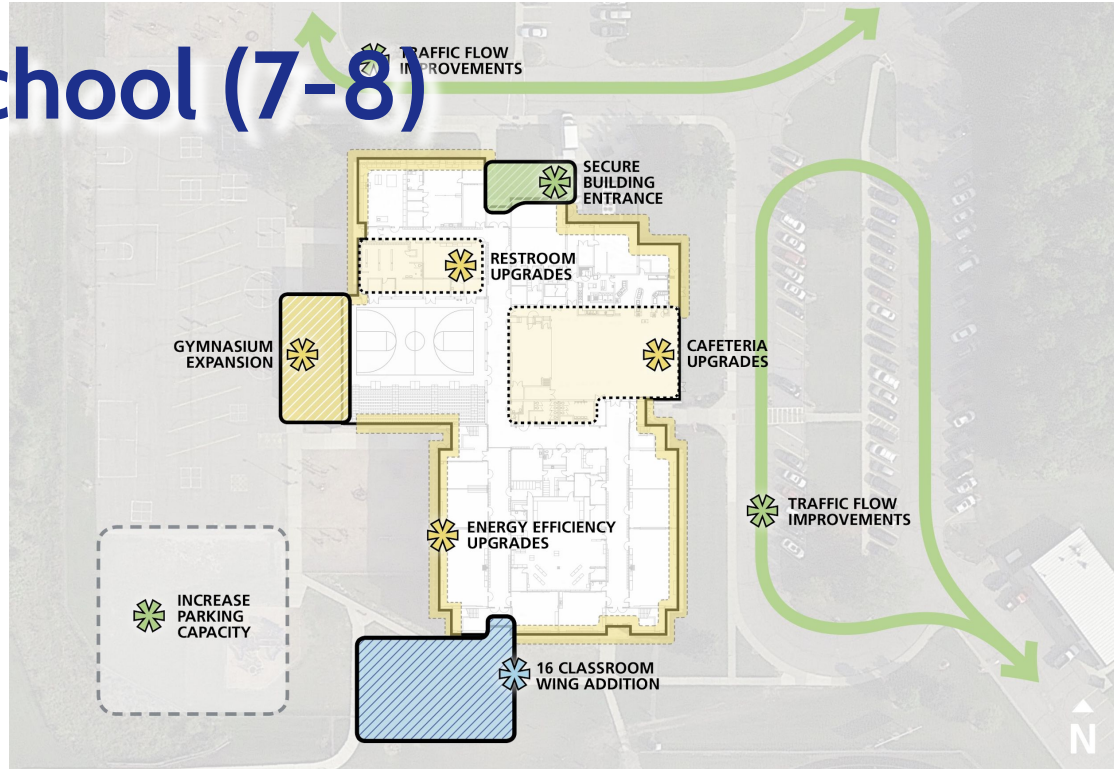

High School (9-12)

Create **SMARTER** Schools



Create **STRONGER** Schools



Create **SAFER** Schools

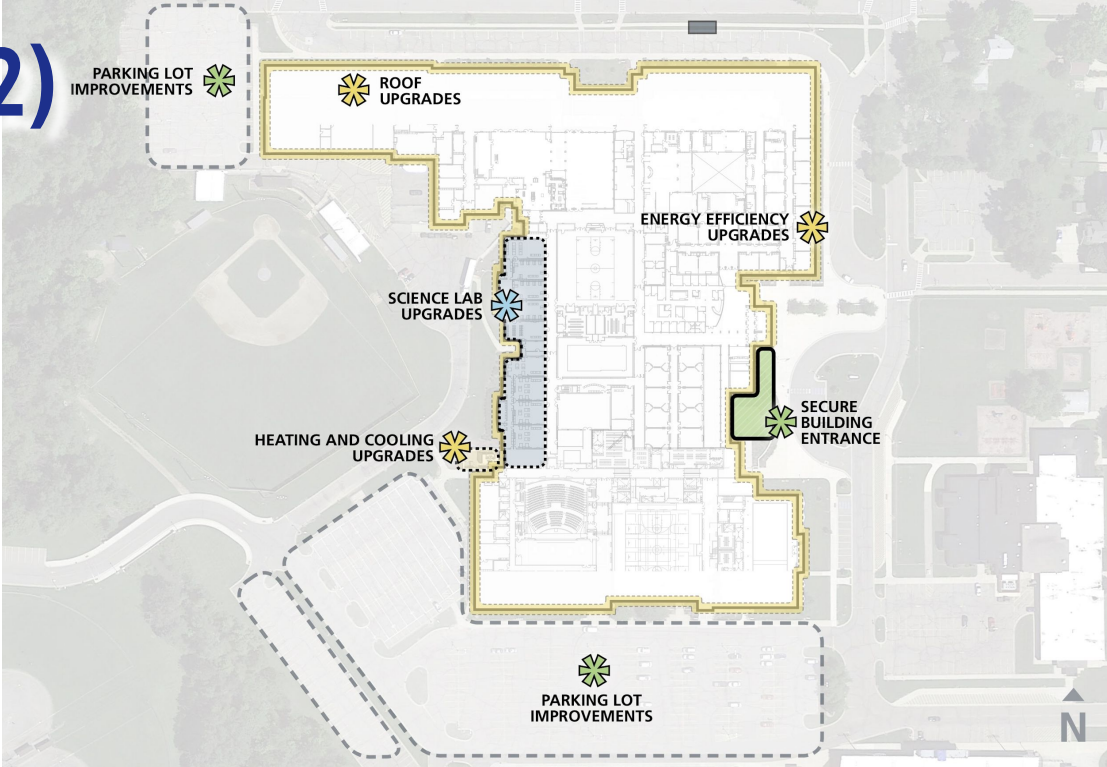

Dave & Betty Morris Vocational Building

- Build a “vocational” school on the 100 acres that Dave & Betty Morris donated to the district
- Develop (STEAM) program to support vocation students
 - Science
 - Technology
 - Engineering
 - Agriculture
 - Mathematics

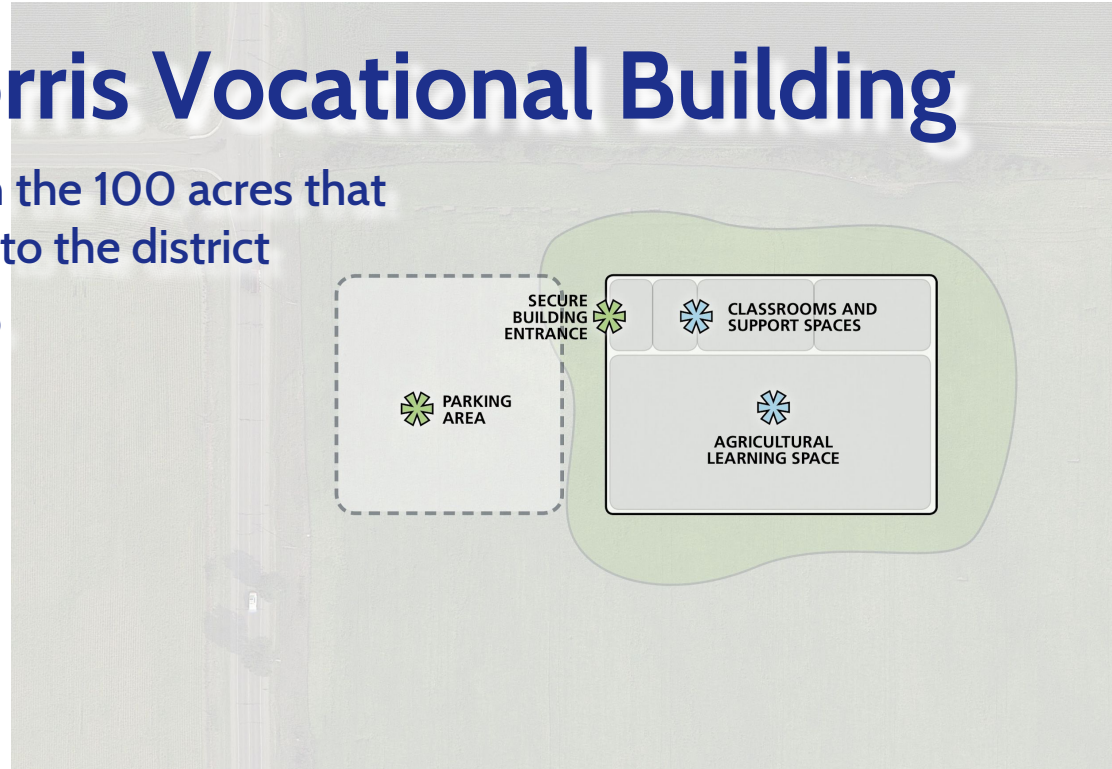

Questions & More Information

- What questions do you have?
- More information at our website: www.glcomets.net
- Dr. Brian Metcalf, 517-925-5400, metcalfb@glcomets.net

Paid for by Grand Ledge Public Schools, 220 Lamson Street, Grand Ledge, Michigan 48837



Grand Ledge
Public Schools
A Community Committed to Excellence

#PROUDTOBEACOMET

